

Guardian Class 2 Biological Safety Cabinet



Features & Benefits

INFO

- Recirculating Technology
- Energy Efficient
- ISO 5 Clean Environment
- High-Quality HEPA Filters
- Public Health Agency Tested
- Infra-Red Intelligent Sash Safety

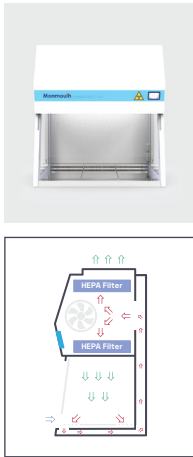

Guaranteed Sample, Personnel & Environmental Protection

The Solution

The Guardian Class 2 Biological Safety Cabinet is an essential tool for laboratories handling biohazardous materials, offering guaranteed protection to the user, the environment, and the sample.

Equipped with H14 HEPA filters, [99.97% efficiency for particles down to 0.3 microns], the cabinet maintains an ISO Class 5 clean environment, essential for microbiological, pharmaceutical, and clinical applications.

How it Operates

The cabinet operates by creating a controlled airflow environment.

HEPA-filtered vertical laminar airflow protects samples from contamination while simultaneously filtering air away from the operator to ensure personal safety.

The air passes through the work zone, collecting any potentially harmful particles, and is then exhausted through a second HEPA filter to prevent environmental contamination.



Technical Information

INFO

	MSC800	MSC1200	MSC1800
External Dimensions (W x D x H)	800mm x 750mm x 1321mm *	1200mm x 750mm x 1321mm *	1800mm x 750mm x 1321mm *
Internal Dimensions (W x D x H)	707mm x 510mm x 741mm	1107mm x 510mm x 741mm	1707mm x 510mm x 741mm
Air Cleanliness	ISO Class 5		
Primary Filter	H14 HEPA Filter - 99.97% efficient at 0.3µm		
Power Consumption	100 watts	150 watts	320 watts
Sound Level	circa. 54dB(A)		circa. 56dB(A)

*HEPA outlet +46mm/optional carbon outlet +55mm | Double HEPA & carbon outlet +129mm

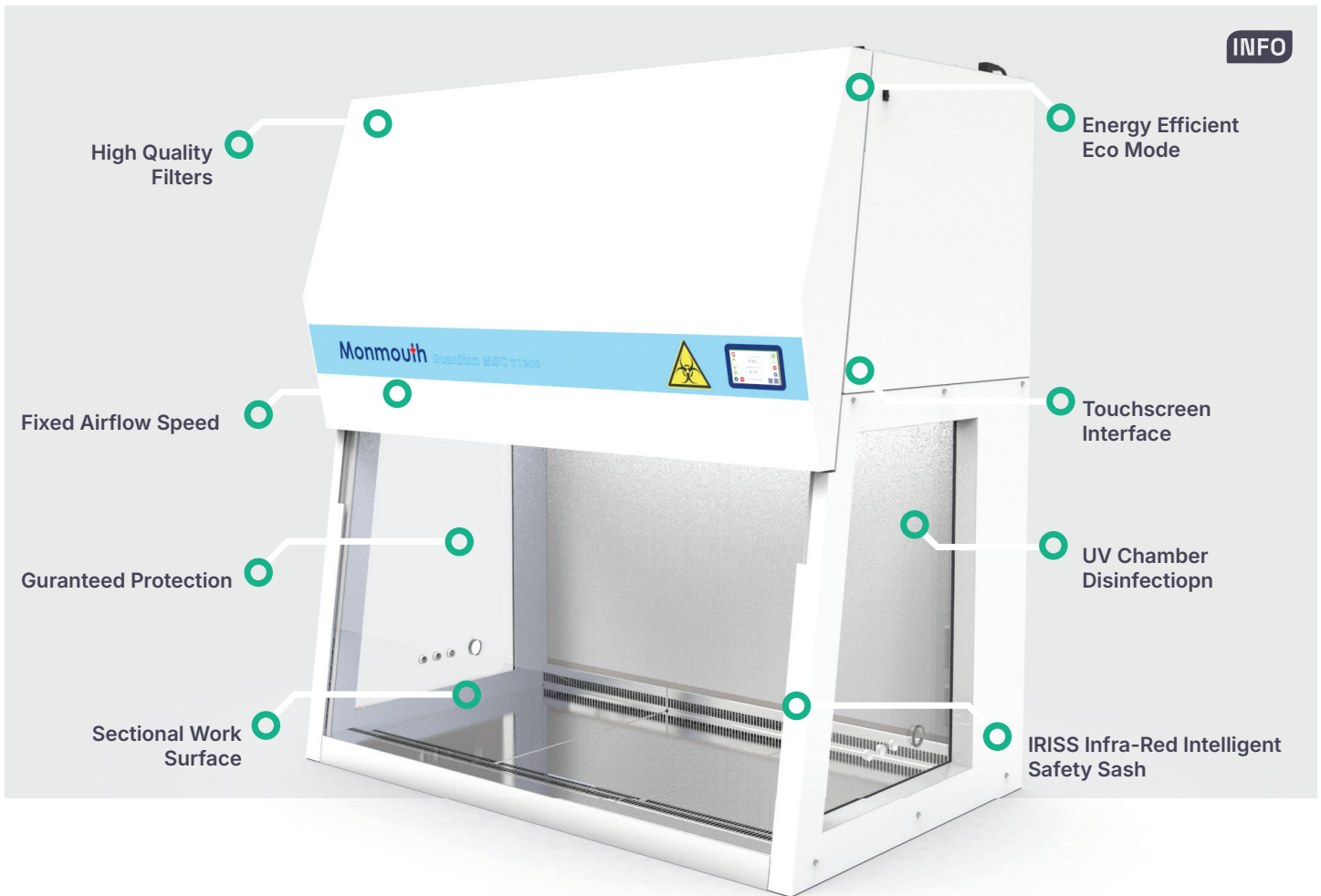

Guaranteed Protection

High quality HEPA filters are 99.97% efficient at 0.3 microns, creating an ISO 5 clean environment.



UV Chamber Disinfection

Pre-programmed start and finish ensures efficient and complete disinfection.

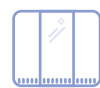
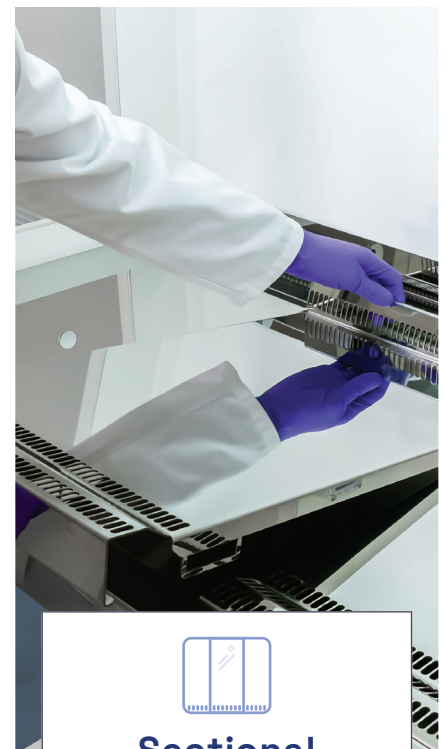

Sectional Work Surface

Mirror finish 316-grade stainless steel, include profiled air in-take grilles to ensure efficient airflow.

Controlled clean environments for critical applications

Fume Containment | Biological Safety | Modular Cleanrooms | Powder Handling | Laminar Flow

Monmouth Scientific

UK Headquarters

Monmouth House,
Peninsula Business Park,
Bristol Road, Bridgwater,
Somerset,
TA6 4QB.

www.monmouthscientific.co.uk

info@monmouthscientific.co.uk
+44(0)1278 458090

Monmouth
Scientific



PART OF THE
SDi GROUP